

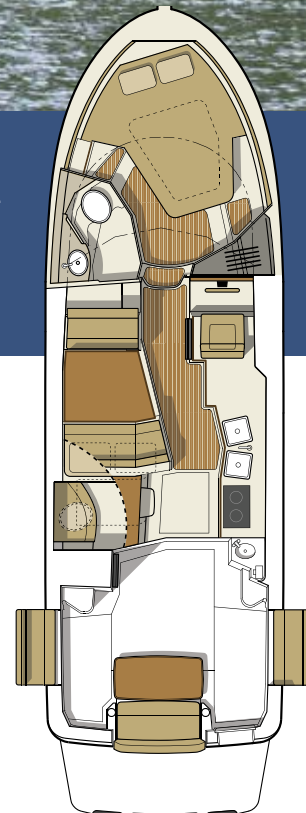

R-31 CB



The R-31 CB was the first Ranger Tug to feature a command bridge. It is equipped with electronic controls at both the upper and lower helm stations and the redesigned bridge has a table and room to seat six. The command bridge also retracts to allow for trailering. She comes standard with bow and stern thrusters for ease of handling. The foredeck features seating and a table that can be raised for entertaining and lowered while underway. The generous cockpit also features wraparound seating utilizing hidden seats that fold out of the gunwale. The interior layout of the R-31 CB features two staterooms - one large island berth forward with en suite head and a midship berth with day head. A starboard side door provides easy access from the lower helm to the side decks for line handling. Like all Ranger Tugs, the R-31 CB comes essentially turn-key with standard features and equipment intended to make her owner's experience hassle-free and allow for ease of handling and comfort under way.



Specifications

| | | |
|--------------------------------------|--|-------------|
| Length (molded) | 31' 2" | 9.5 m |
| Length (w/swim step) | 35' 2" | 10.72 m |
| Beam | 10' | 3.05 m |
| Draft | 28" | .71 m |
| Bridge clearance (bridge/mast up) | 17' 9" | 5.41 m |
| Bridge clearance (bridge/mast down) | 10' 3" | 3.12 m |
| Height on trailer (bridge/mast down) | 13' 4" | 4.06 m |
| Length on trailer | 41' 8" | 12.70 m |
| Fuel capacity | 180 US Gal | 681.37 L |
| Water capacity | 80 US Gal | 302.83 L |
| Hot water | 11 US Gal | 41.64 L |
| Holding tank capacity | 40 US Gal | 151.42 L |
| Weight, Dry | 11,500 lbs | 5,216.31 kg |
| Engine | Volvo D4 300 HP diesel common rail electronic engine | |



Ranger Tugs R-31 CB Value Package **FACTORY DIRECT PRICING**

All Ranger 31 models are sold **fully equipped** and **ready-to-cruise**. There are two packages to choose from, the Luxury Edition with a diesel generator and air conditioning or the Northwest Edition with a diesel forced air furnace and downrigger plugs and pads.

Northwest Edition Included Features:

- AIS 300
- Anchor Package 22# anchor, 50' HT chain, 200' line
- AGM batteries
- Autopilot, dual station, Garmin w/ remote
- **Diesel heater, forced air furnace**
- **Downrigger plugs & pads**
- LED lights
- Macerator discharge
- Navigation package, Garmin 7612 upper/7616 lower, 4kw HD radar dome, GPS ant., depth/ff
- Swim platform rails
- Safety kit
- Solar panel, 145 watt w/control panel
- Thruster wireless remote
- Underwater lights

FULLY EQUIPPED, READY-TO-CRUISE FROM:

\$319,937.00*

Luxury Edition Included Features:

- AIS 300
- **Air conditioning/ rev cycle heat**
- Anchor Package 22# anchor, 50' HT chain, 200' line
- AGM batteries
- Autopilot, dual station, Garmin w/ remote
- **Generator, diesel w/sound shield**
- LED lights
- Macerator discharge
- Navigation package, Garmin 7612 upper/7616 lower, 4kw HD radar dome, GPS ant., depth/ff
- Swim platform rails
- Safety kit
- Solar panel, 145 watt w/control panel
- Thruster wireless remote
- Underwater lights

FULLY EQUIPPED, READY-TO-CRUISE FROM:

\$334,937.00*

Standard Features

Performance

- Volvo 300 HP D4 common rail diesel engine
- Bow and stern thrusters
- Full color electronic engine control display
- Single lever, electronic shift and throttle control
- Trim tabs



Boater Features

- Anchor locker, S.S. self-launching bow roller through stem
- Electrical panels AC/DC
- Command bridge, retractable, compass, second station VHF, electronic controls, thruster control, trim tab control
- Command bridge, seating for six, table for entertaining
- Folding S.S. mast for trailering
- Fuel flow data display
- Pilothouse door, stbd side, sliding, locking
- Powered engine hatch
- Rod holders
- Sea water strainers
- Sport racks
- Swim step w/built-in fenders and swim ladder
- Wash down system, raw water
- Windlass with bow and helm controls

Convenience

- Cabin Heater (engine)
- Cockpit convenience center, sink
- Cockpit table and seating
- Cowl vent (ventilation in forward cabin)



- Dinette, salon, converts to bed, high/low table, sleeps 2
- Double wide, reversible companion seat
- Enclosed head, vessel sink, shower with enclosure
- Foredeck seat and table
- Forward deck hatch, opening translucent
- Hatches (5), pilothouse roof, opening with screens
- Holding tank level monitor
- Inverter, 2000w, PSW
- Island bed, master stateroom (memory foam)
- Lounge seating, dinette converts to lounge for reading
- Marine heads (2), fore and aft, electric, holding tank, pump out
- Midship stateroom, double berth, privacy door, day head
- Outlets 110V (5)
- Microwave
- Portlights, brass, opening with hooks
- Power outlets, 12V port and stbd, master state room, midship
- Refrigerator/freezer, galley, 12V
- Refrigerator/freezer, cockpit, 12V
- Sinks (4), fresh water system w/demand pump, H and C
- Storage lockers (6), cabin, w/teak louvered doors
- Stove/oven, propane, two burner, includes propane box, (2) tanks
- Transom door for easy boarding
- Visor/drip rails, fwd and side windows
- Water tank level monitor (fresh)
- Windshield wipers (4) pantographic
- Wine cooler - water, 12V, (6) bottle

Safety

- Diesel power
- Co Monitors (2), 12V
- Courtesy lights, cockpit entry steps, swim step, and walkways



- Dual trumpet electric horn
- Illuminated compasses (2)
- Navigation lights, with light boards
- Spotlight w/remote control
- VHF radio (dual station), Garmin with ant., DSC capable
- Window defrosters

Entertainment

- Entertainment center, master stateroom with 22" TV/DVD
- Entertainment center, salon with 19" overhead TV/DVD
- Fusion stereo system, (8) speakers, Bluetooth (controllable through Garmin GPS)

Construction

- Bonded electrical system
- Bronze rudder, propeller, and thru-hulls
- Fiberglass cockpit liner, self-bailing w/non-skid
- Fiberglass stringer
- S.S. cleats, rails, ext. hardware
- Sunbrella fabrics
- Teak and Holly cabin sole
- Vinylester barrier coat (hull)



Additional Factory Options

| | |
|---|----------|
| Aft cockpit sun shade with sunset shade | \$1,500 |
| Aft steering, second station with electronic controls | \$4,970 |
| Aluminum triple axle trailer, electric/hydraulic brakes, spare tire w/bracket | \$15,600 |
| Bimini top, command bridge, helm seating only | \$3,440 |
| Carpet runner, Teak and Holly, cockpit | \$720 |
| Carpet runner, Teak and Holly, interior | \$620 |
| Cockpit ice maker (in lieu of cockpit refrigerator) | \$470 |
| Cockpit sun shade with sunset shade | \$1,499 |
| Dinghy, inflatable RIB 290 CSM hypalon with Weaver davits, stand-off & winch | \$5,125 |
| Dinghy motor, Yamaha F2.5, 4-stroke, storage bracket | \$1,115 |
| Dinghy motor, Yamaha F6, 4-stroke, storage bracket | \$1,945 |
| Dinghy motor, Yamaha F9.9, 4-stroke, storage bracket | \$2,935 |
| Factory Delivery Experience | \$2,500 |
| Garmin GXM 52 XM/weather antenna | \$870 |
| International option, 240v | \$900 |
| Low speed module | \$2,000 |

*Options, freight & taxes extra

Prices, specifications, equipment and options may change without notice. 1017



MADE IN USA



25802 Pacific Highway South
Kent, WA 98032
Phone 253-839-5213

www.RangerTugs.com

